

SoloCem[®] CEMENTATION OF CROWNS, BRIDGES, INLAYS, ONLAYS

Optional: ONE COAT 7 UNIVERSAL on tooth

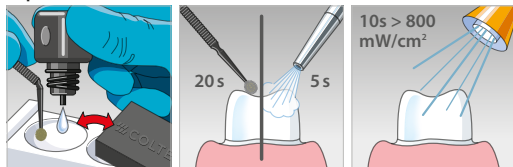

If improved bond strength is required

Preparation of restoration

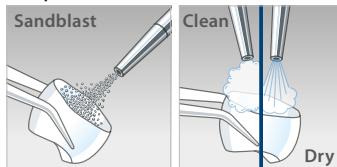

⚠ Manufacturer's IFU

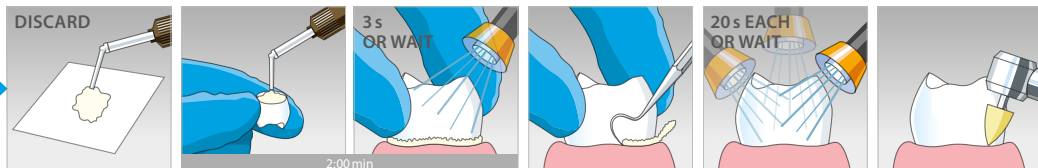

Composite, Metal, Zirconia

Optional: ONE COAT 7 UNIVERSAL on tooth

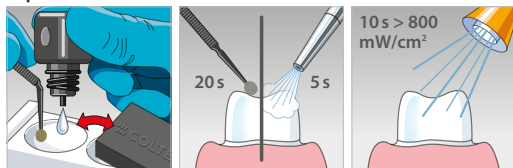

If improved bond strength is required

Preparation of restoration

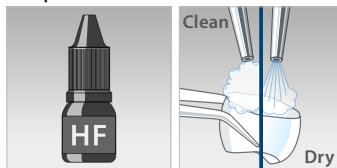

⚠ Manufacturer's IFU

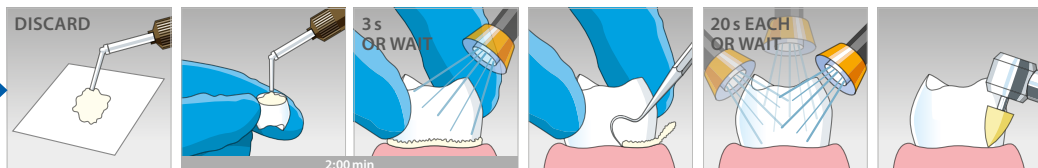

Silicate Ceramics

Optional: ONE COAT 7 UNIVERSAL on tooth

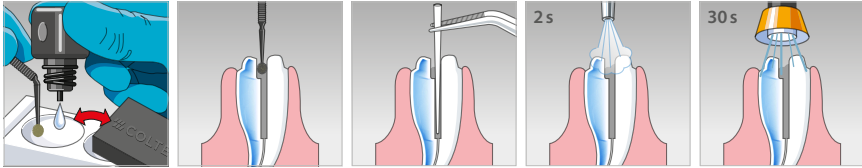

If improved bond strength is required

⚠ Manufacturer's IFU

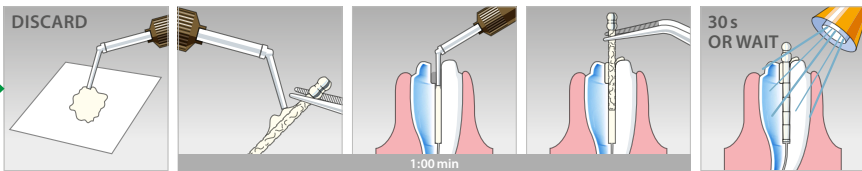

⚠ For detailed instructions for preparation of root canal and post, please always consider the instructions for use provided by the post's manufacturer.

Dos

- The use of a dental dam is recommended
- For improved bond strength, use ONE COAT 7 UNIVERSAL on the tooth
- Always consider the manufacturer's instructions for use of indirect restoration materials

Don'ts

- Do not etch dentin with phosphoric acid
- Do not dry out dentin
- Do not use ONE COAT 7 UNIVERSAL without light curing

Questions?

Please contact your sales representative for any question or visit:

www.coltene.com

