

# MTA vpt

Material for vital pulp therapy



## Indications

- Base fill cement for all restorative materials
- Indirect pulp capping
- Direct pulp capping
- Treatment of pulp following vital amputation

## Advantages

- MTA for everyday clinical practice – biocompatible, free of monomers
- High pH value (12) – known for its bacteriostatic effect
- Release of calcium and hydroxide ions – promotes formation of tertiary dentine and remineralisation
- Reliable pulp protection – mineralises to form a bacteria-proof seal
- Time-efficient – immediate further processing thanks to layering without pressure
- Easy handling – application with standard instruments, or directly from the capsule
- No product-related discolouration – free of bismuth oxide and ferrous compounds
- Radiopaque (290 % Al)

## Application

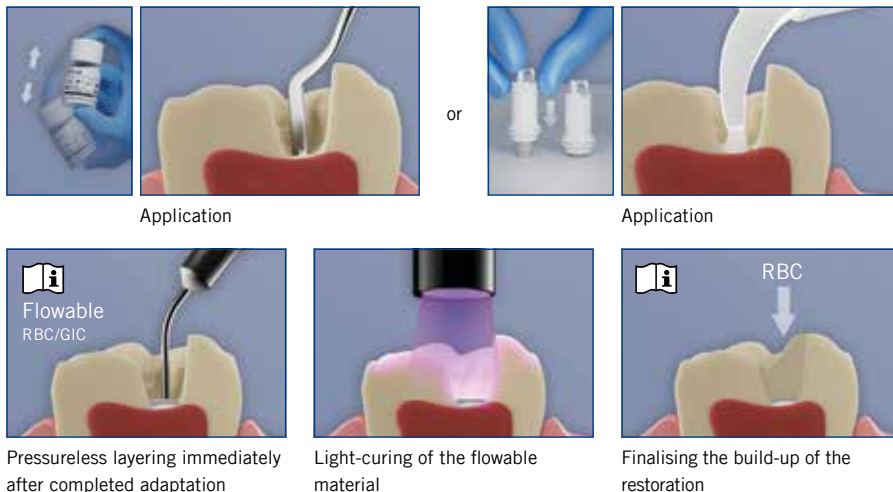

RBC = Resin Based Composite



REF 1645	Powder 10 g / liquid 10 ml
REF 1646	Application capsule 25 pcs. <i>(available from 01.06.2025)</i>

Liner

Bonding

Restoratives (ORMOCER®s)

Restoratives (Composites)

Restoratives (Compomers)

Restoratives (Glass ionomer materials)